

INQUADRAMENTO scala 1:2000



REGIONE PUGLIA

COMUNE DI UGENTO

APPALTO PER: PROGETTAZIONE ESECUTIVA ED ESECUZIONE DEI LAVORI DI VALORIZZAZIONE E RIQUALIFICAZIONE INTEGRATA DEI PAESAGGI COSTIERI DEL COMUNE DI UGENTO
Cup: F97B15000250008- CIG64495164F8

IMPRESA ESECUTRICE



Via Tito Minniti, 13/D - 73100 Lecce (LE)

PROGETTISTA



Via Imbrani, 36 - 73100 Lecce (LE)

CONSULENTI

Dott. Agron. Vincenzo MELLO
Arch. Paesag. Umberto MELLO
Arch. Paesag. Alessandro MELLO

ELABORATI REDATTI PER LA CONFERENZA DEI SERVIZI AI SENSI DELLA LEGGE N.241 DEL 07/08/1990 e s.m.i

PERCORSO CICLOTURISTICO,
PONTE PEDONALE

E.28

scale varie

NOVEMBRE 2016

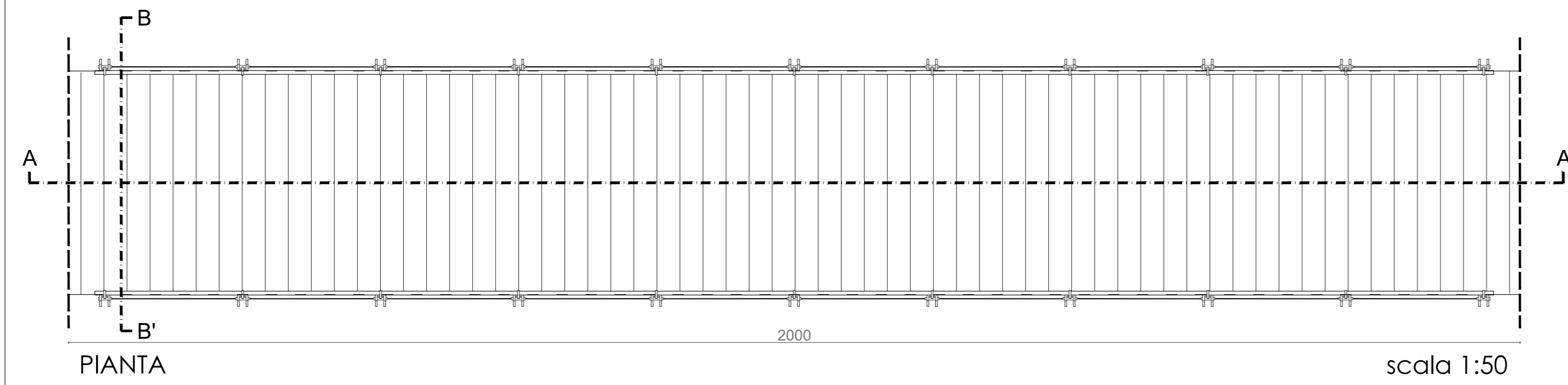
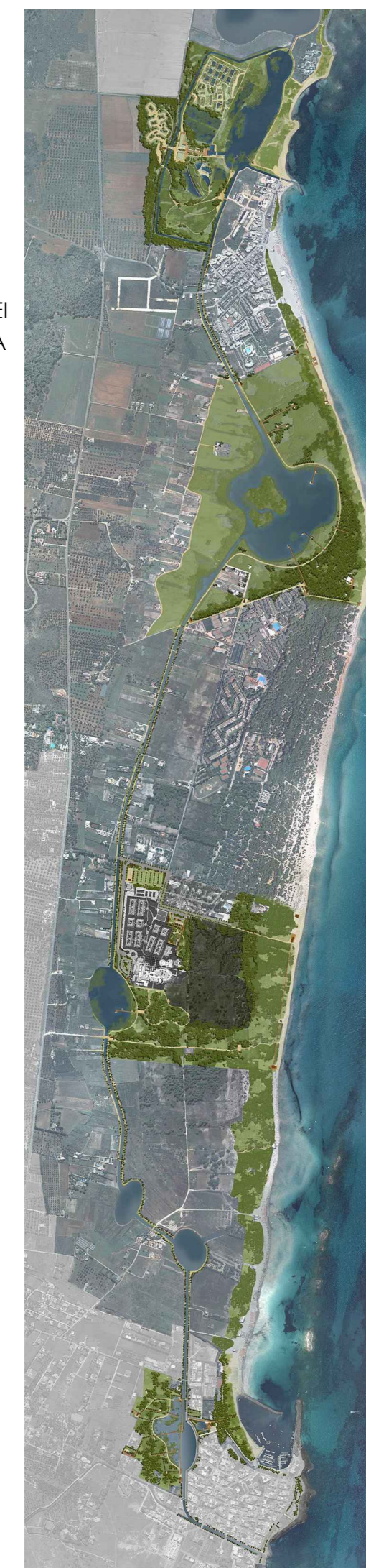

PIANTA

scala 1:50

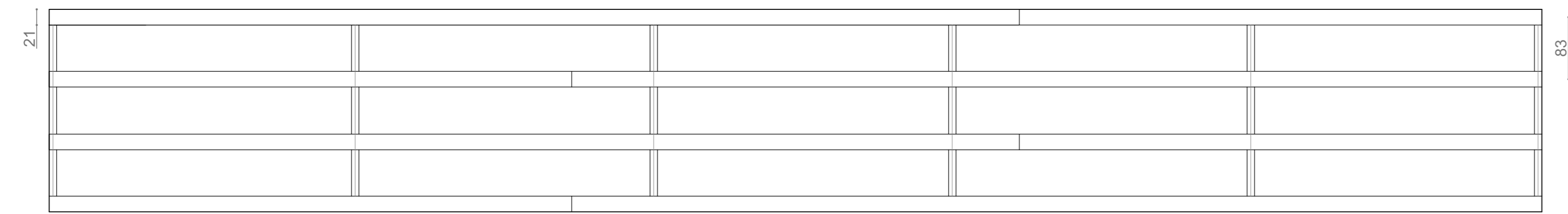

SCHEMA SOTTOSTRUTTURA

scala 1:50

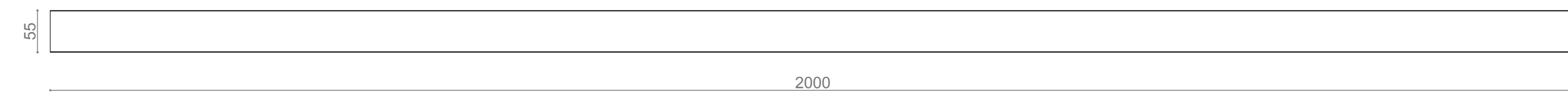

IRRIGIDIMENTO PRINCIPALE TRAVE IPE 550

scala 1:50

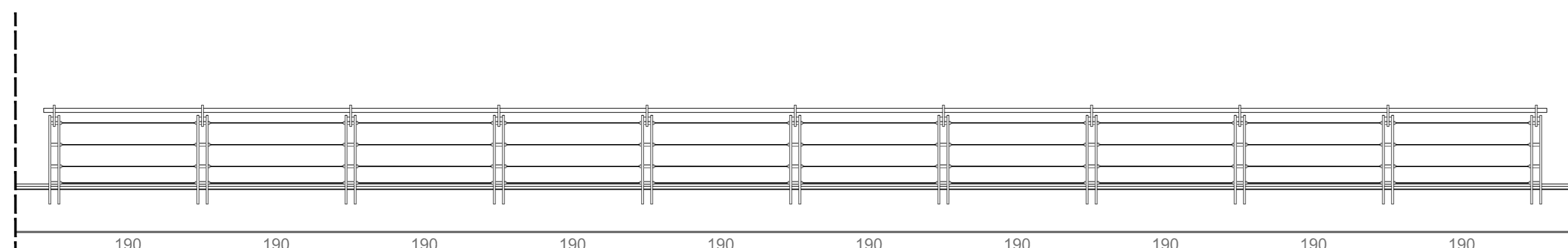

PROSPETTO

scala 1:50

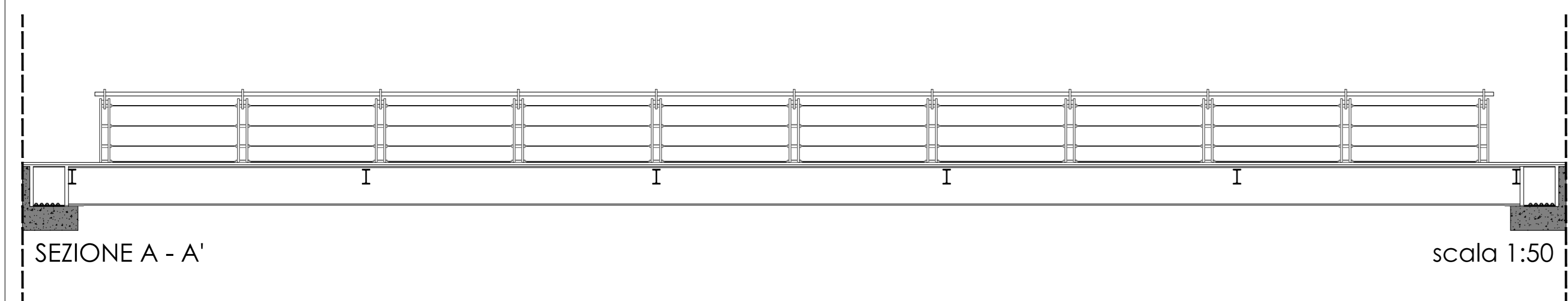

SEZIONE A - A'

scala 1:50

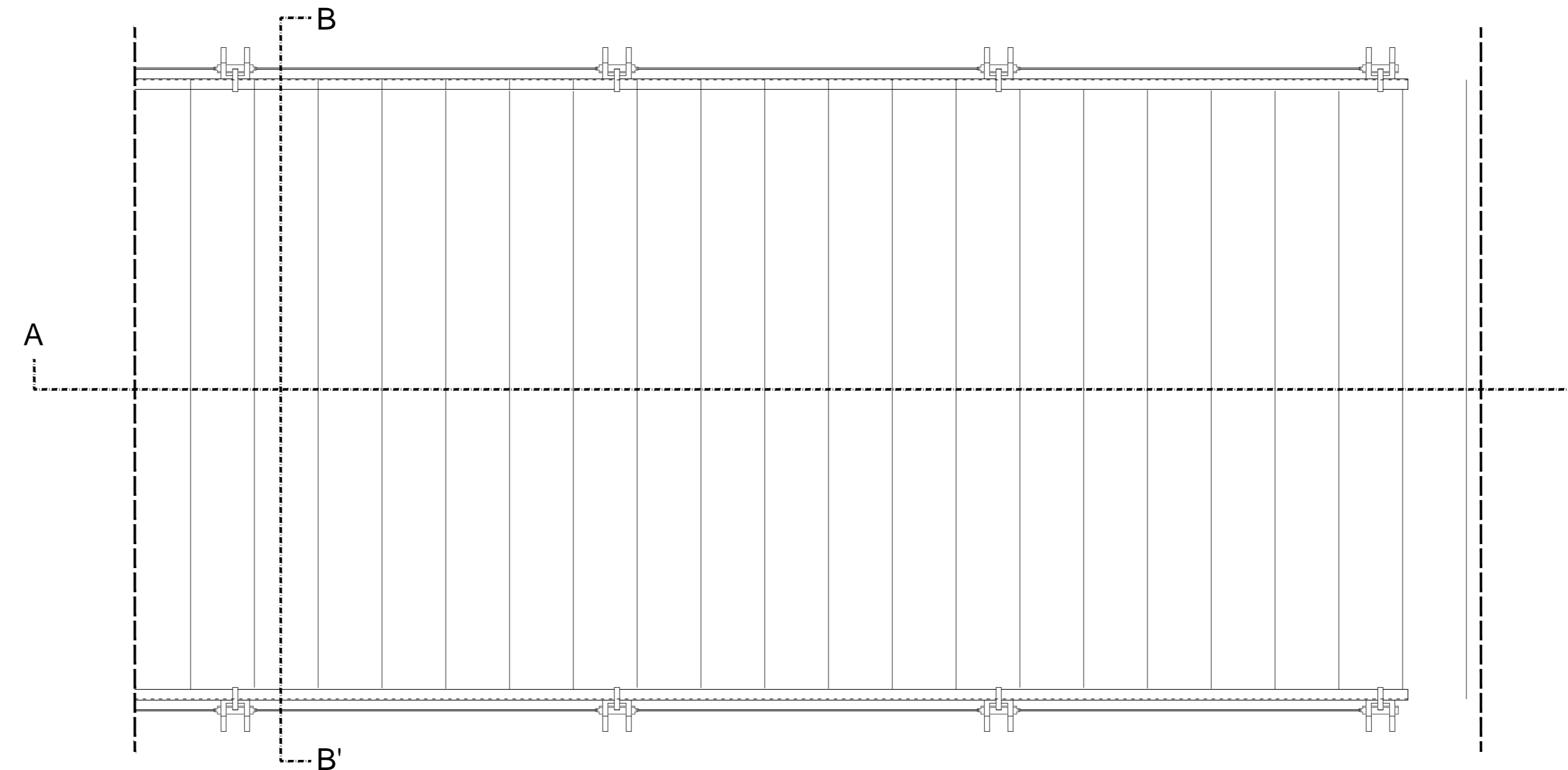

SEZIONE A - A'

scala 1:20

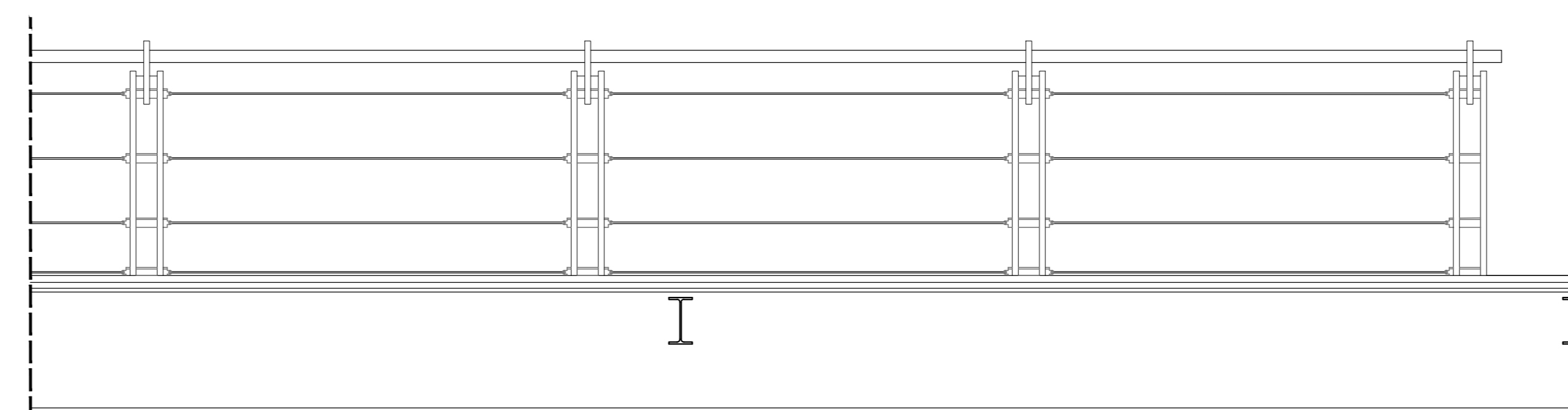

SEZIONE A - A'

scala 1:20

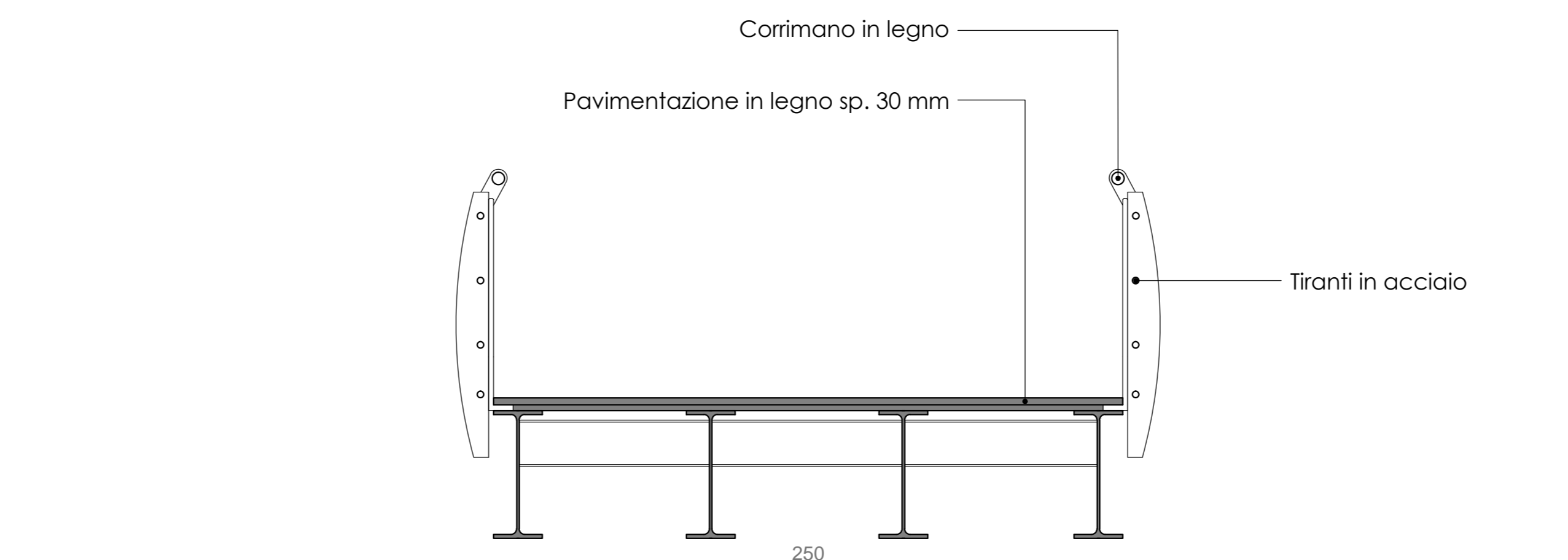

SEZIONE B - B'

scala 1:20

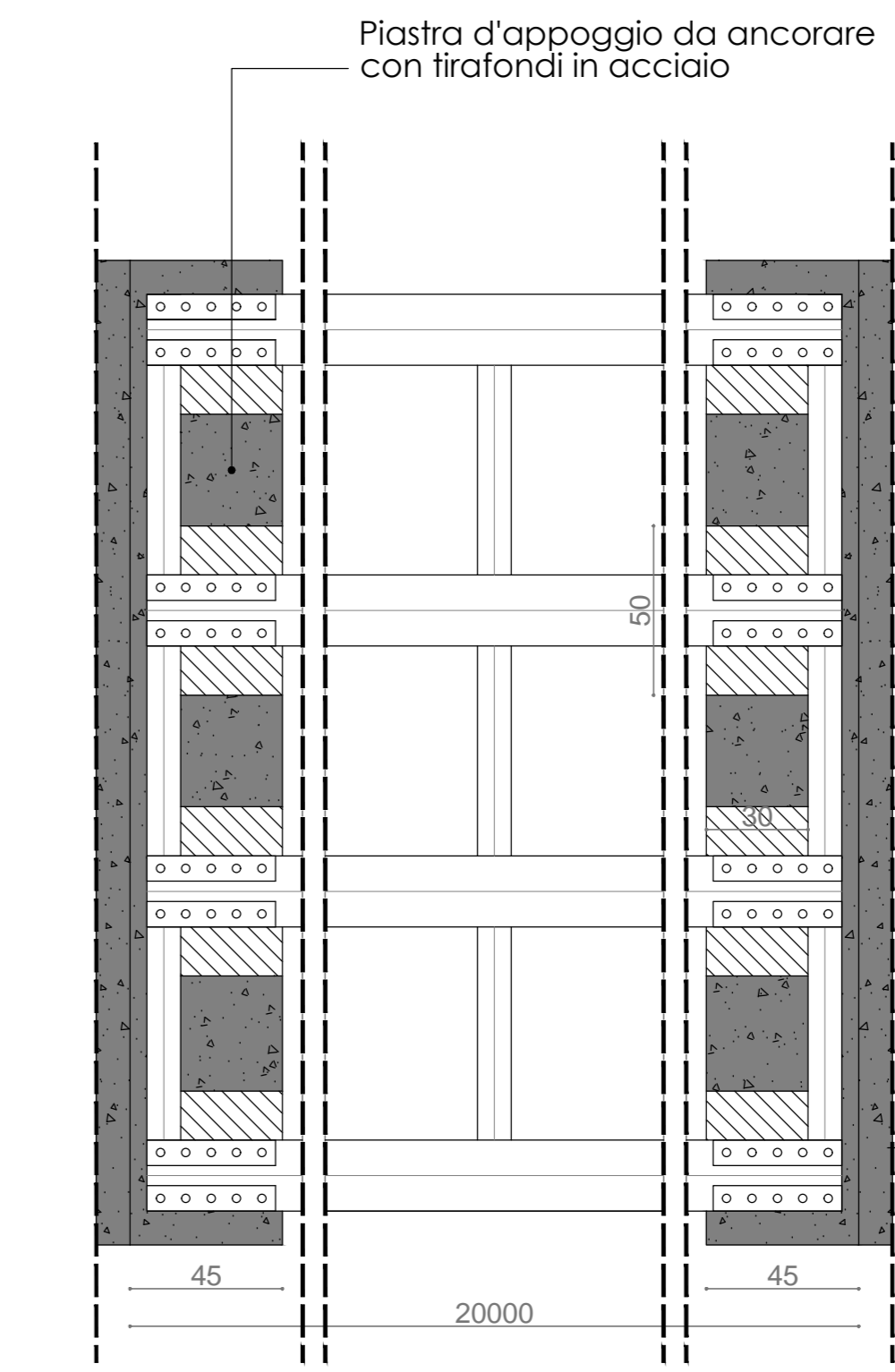

PARTICOLARE CARPENTERIA

scala 1:20

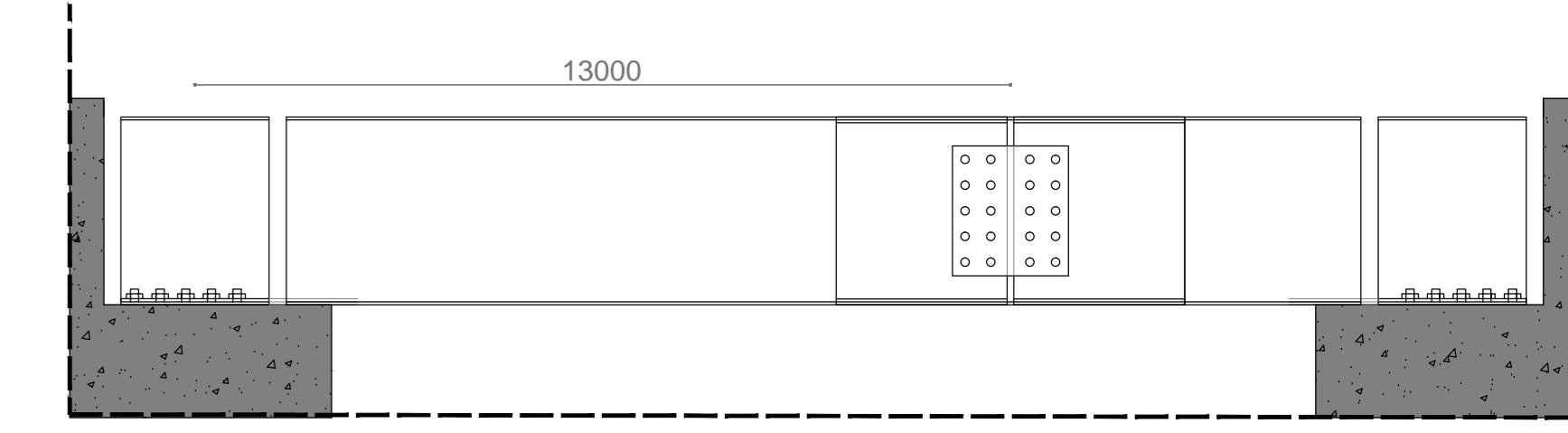

PARTICOLARE UNIONE TRAVE - TRAVE

scala 1:20

MATERIALI: ACCIAIO FE 360, BULLONERIA M16 cl. 8.8

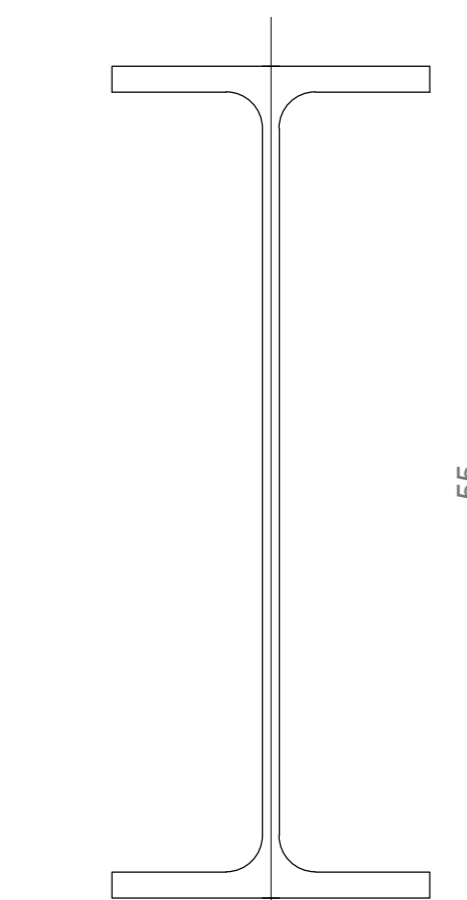

TRAVI PRINCIPALI IPE 550

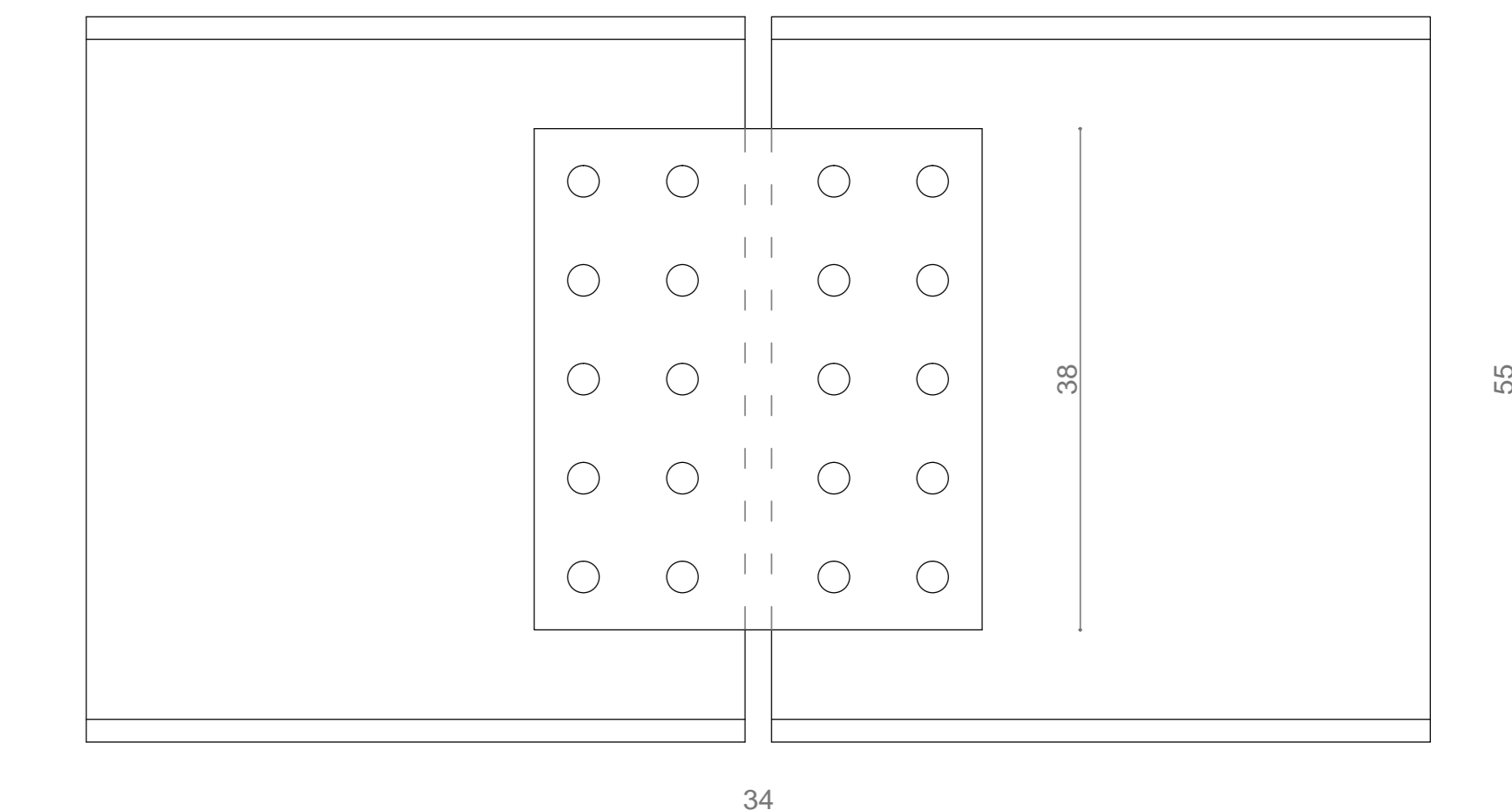

scala 1:5

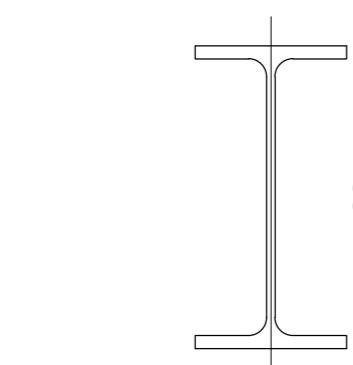

IRRIGIDIMENTO TRASVERSALE TRAVE IPE 200 i:4000

UNIONE TRAVE - TRAVE

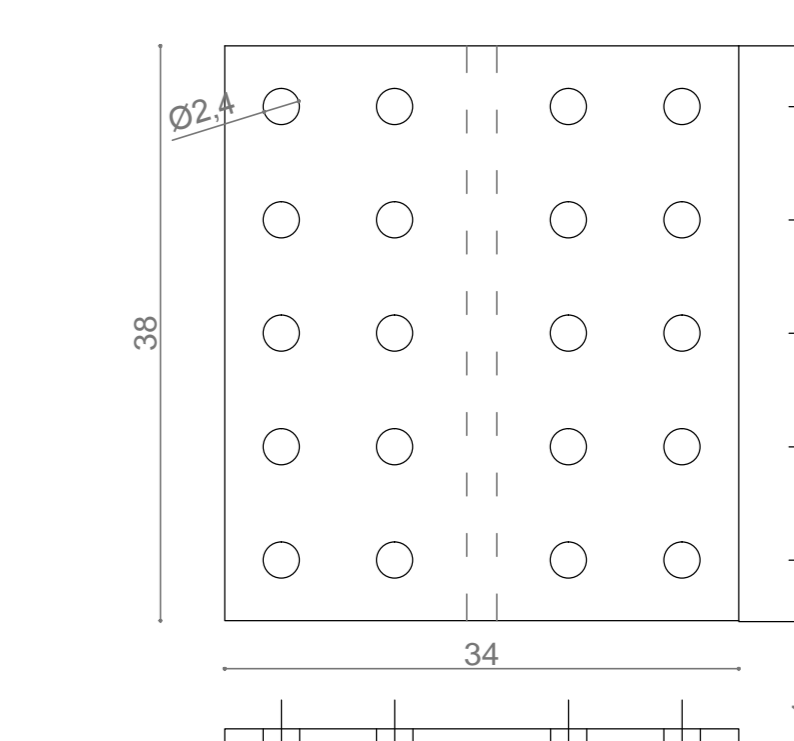

UNIONE TRAVE - SPALLA IN C.A.

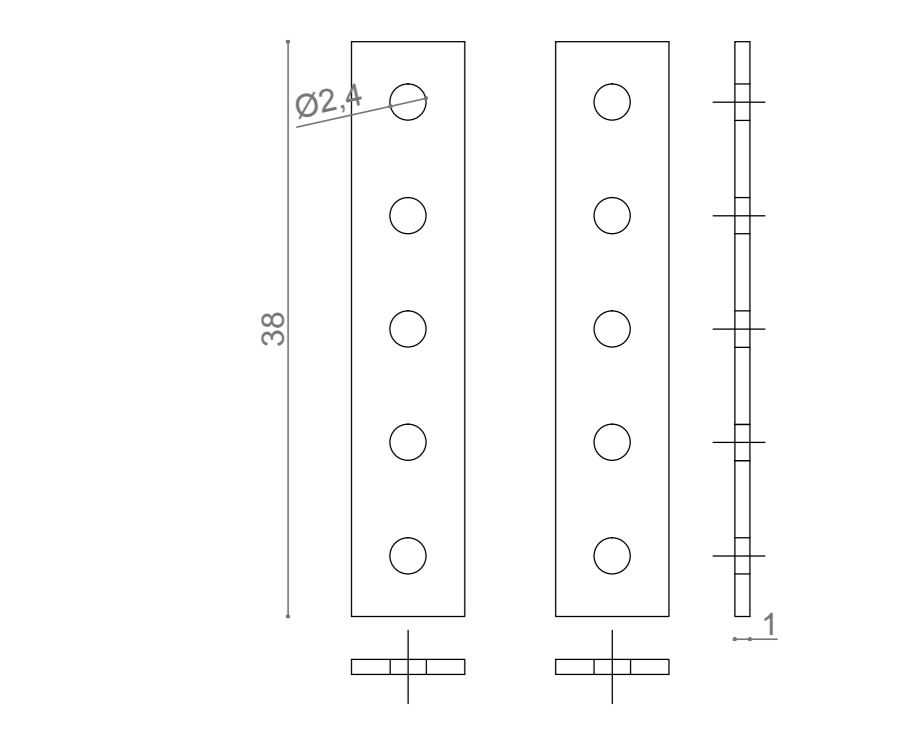

scala 1:5